

# Rometec srl

www.rometec.it

## Raccorderia filettata inox

### Indice generale

Attacco per serbatoi.....	2
Gomiti Femmina.....	2
Guarnizioni.....	3
Gomito maschio – femmina.....	3
Gomito a 45° femmina.....	4
Union a T femmina (tee).....	4
Raccordo a saldare.....	5
Manicotto di riduzione.....	5
Riduzione BSPT.....	6
Riduzione BSPP-F x BSPT-M.....	6
Nipplo di riduzione.....	7
Manicotto.....	8
Nipplo.....	8
Nipplo corto.....	9
Tappo maschio.....	9
Tappo femmina.....	10
Dado.....	10
Giunto a 3 pezzi femmina.....	11
Giunto a 3 pezzi maschio - femmina.....	11
Portagomma.....	12

Tutta la raccorderia seguente è inox, ma è possibile richiederla anche in ottone.

Qui di seguito trovate le combinazioni più comuni, ma potete richiederci degli speciali su vostro disegno.

## Attacco per serbatoi

AISI 316 SS, BSP ISO 228

Misure

Codice	Taglia	L	Hx	Peso
VCTW3A028502	1/4"	40	22	0,05
VCTW3A028503	3/8"	45	27	0,08
VCTW3A028504	1/2"	57	32	0,12
VCTW3A028505	3/4"	57	37	0,18
VCTW3A028506	1"	69	46	0,29
VCTW3A028507	1-1/4"	69	55	0,36
VCTW3A028508	1-1/2"	69	62	0,49
VCTW3A028509	2"	82	76	0,76

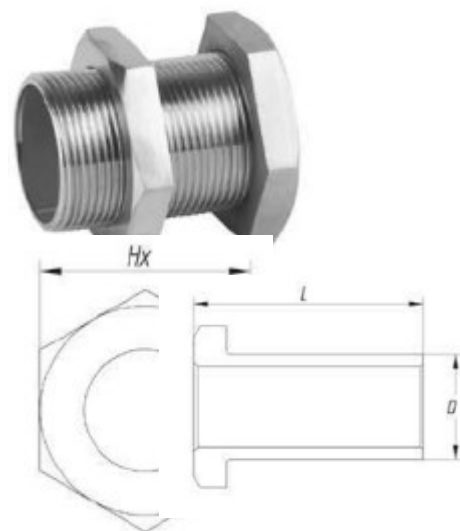

## Gomiti Femmina

AISI 316 SS, BSP (ISO 7/1), PN 10

Codice	Taglia	L1	Peso
VCTW3A009002	1/4"	19	0,06
VCTW3A009003	3/8"	25	0,07
VCTW3A009004	1/2"	28	0,1
VCTW3A009005	3/4"	33	0,16
VCTW3A009006	1"	38	0,26
VCTW3A009007	1-1/4"	45	0,4
VCTW3A009008	1-1/2"	48	0,5
VCTW3A009009	2"	58	0,74
VCTW3A009010	2-1/2"	69	1,36
VCTW3A009011	3"	78	1,48
VCTW3A009012	4"	96	2,76

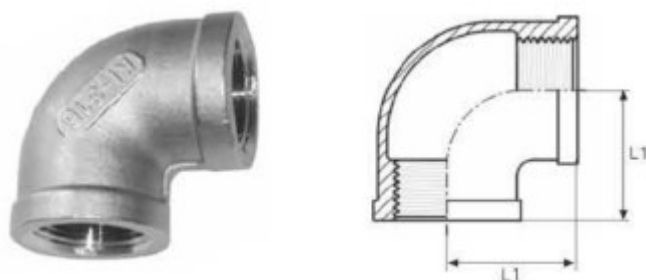

## Guarnizioni

Tutte le misure sa 1/4" a 2" , 316 SS



Codice	Taglia	D	d	Peso
VCTW3A006002	1/4"	33,2	14,2	0,01
VCTW3A006003	3/8"	41,5	18,2	0,01
VCTW3A006004	1/2"	47,5	21,8	0,02
VCTW3A006005	3/4"	59,5	28,5	0,03
VCTW3A006006	1"	65	34,2	0,03
VCTW3A006007	1-1/4"	75	42,5	0,04
VCTW3A006008	1-1/2"	80	48,5	0,09
VCTW3A006009	2"	91	60,5	0,04

## Gomito maschio – femmina

AISI 316 SS, BSP (ISO 7/1), PN 10

Codice	Taglia	L1	L2	Peso
VCTW3A009202	1/4"	18	30	0,07
VCTW3A009203	3/8"	32	34	0,08
VCTW3A009204	1/2"	26	39	0,1
VCTW3A009205	3/4"	30	49	0,17
VCTW3A009206	1"	33	52	0,22
VCTW3A009207	1-1/4"	46	60	0,38
VCTW3A009208	1-1/2"	47	65	0,49
VCTW3A009209	2"	56	76	0,78
VCTW3A009210	2-1/2"	69	93	1,25
VCTW3A009211	3"	78	107	1,85
VCTW3A009212	4"	96	115	3,11

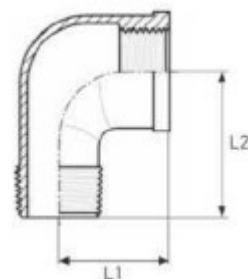

## Gomito a 45° femmina

AISI 316 SS, BSP (ISO 7/1), PN 10

Codice	Taglia	L1	L2	Peso
VCTW3A012002	1/4"	17	17	0,05
VCTW3A012003	3/8"	19	19	0,08
VCTW3A012004	1/2"	22	22	0,1
VCTW3A012005	3/4"	25	25	0,15
VCTW3A012006	1"	29	29	0,22
VCTW3A012007	1-1/4"	33	33	0,34
VCTW3A012008	1-1/2"	36	36	0,42
VCTW3A012009	2"	42	42	0,62
VCTW3A012010	2-1/2"	47	47	1,13
VCTW3A012011	3"	52	52	1,25
VCTW3A012012	4"	70	70	2,1

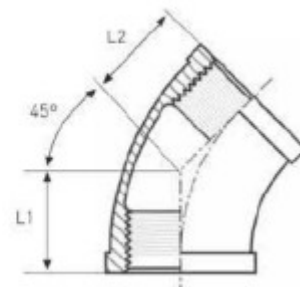

## Union a T femmina (tee)

AISI 316 SS, BSP (ISO 7/1), PN 10

Codice	Taglia	L1	Peso
VCTW3A013002	1/4"	19	0,08
VCTW3A013003	3/8"	25	0,1
VCTW3A013004	1/2"	28	0,15
VCTW3A013005	3/4"	33	0,22
VCTW3A013006	1"	38	0,36
VCTW3A013007	1-1/4"	45	0,57
VCTW3A013008	1-1/2"	48	0,67
VCTW3A013009	2"	56	1,05
VCTW3A013010	2-1/2"	69	1,75
VCTW3A013011	3"	78	1,95
VCTW3A013012	4"	96	3,22

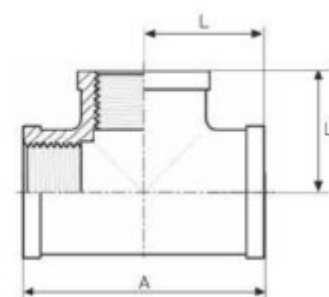

## Raccordo a saldare

AISI 316L SS, BSP (ISO 7/1), PN 10

Codice	Taglia	D	L	E	B	Peso
VCTW3A014902	1/4"	13,6	25	2,3	10	0,02
VCTW3A014903	3/8"	17,2	25	2,3	10	0,03
VCTW3A014904	1/2"	21,3	35	2,6	13	0,04
VCTW3A014905	3/4"	26,9	40	2,6	15	0,06
VCTW3A014906	1"	33,7	40	3,2	17	0,08
VCTW3A014907	1-1/4"	42,4	50	3,2	19	0,13
VCTW3A014908	1-1/2"	48,3	50	3,6	19	0,14
VCTW3A014909	2"	60,3	50	3,6	23	0,22
VCTW3A014910	2-1/2"	76,1	60	3,6	27	0,28
VCTW3A014911	3"	88,9	70	4	30	0,71
VCTW3A014912	4"	114,3	80	4,5	36	1,1

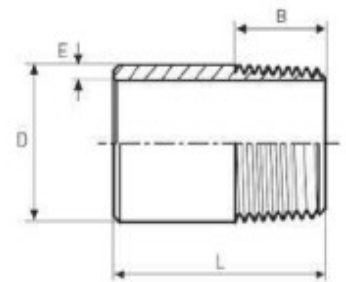

## Manicotto di riduzione

AISI 316 SS, BSP (ISO 7/1), PN 10; disponibile anche in ottone

Codice	Taglia	L	Peso
VCTW3A02400201	1/4"x1/8"	25	0,03
VCTW3A02400302	3/8"x1/4"	28	0,05
VCTW3A02400402	1/2"x1/4"	34	0,07
VCTW3A02400403	1/2"x3/8"	34	0,07
VCTW3A02400503	3/4"x3/8"	38	0,1
VCTW3A02400504	3/4"x1/2"	38	0,12
VCTW3A02400603	1"x3/8"	42	0,15
VCTW3A02400604	1"x1/2"	42	0,15
VCTW3A02400605	1"x3/4"	42	0,15
VCTW3A02400704	1-1/4"x1/2"	48	0,2
VCTW3A02400705	1-1/4"x3/4"	48	0,24
VCTW3A02400706	1-1/4"x1"	48	0,23
VCTW3A02400805	1-1/2"x3/4"	52	0,3
VCTW3A02400806	1-1/2"x1"	52	0,3
VCTW3A02400807	1-1/2"x1-1/4"	52	0,3
VCTW3A02400906	2"x1"	59	0,42
VCTW3A02400908	2"x1-1/2"	58	0,45

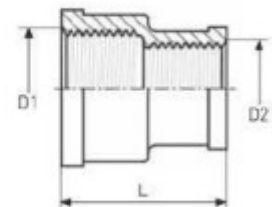

## Riduzione BSPT

AISI 316 SS, BSP (ISO 7/1), PN 10; disponibile anche in ottone

Codice	Taglia (D1 x D2)	L	SW	Peso (kg)
VCTW3A02410201	1/4"x1/8"	17	14	0,01
VCTW3A02410302	3/8"x1/4"	18	19	0,01
VCTW3A02410402	1/2"x1/4"	21	22	0,04
VCTW3A02410403	1/2"x3/8"	21	22	0,03
VCTW3A02410503	3/4"x3/8"	24	30	0,06
VCTW3A02410504	3/4"x1/2"	24	30	0,05
VCTW3A02410603	1"x3/8"	26	36	0,1
VCTW3A02410604	1"x1/2"	26	36	0,1
VCTW3A02410605	1"x3/4"	26	36	0,08
VCTW3A02410704	1-1/4"x1/2"	29	46	0,19
VCTW3A02410705	1-1/4"x3/4"	29	46	0,17
VCTW3A02410706	1-1/4"x1"	29	46	0,13
VCTW3A02410805	1-1/2"x3/4"	31	50	0,31
VCTW3A02410806	1-1/2"x1"	31	50	0,27
VCTW3A02410807	1-1/2"x1-1/4"	31	50	0,2
VCTW3A02410906	2"x1"	35	65	0,35
VCTW3A02410907	2"x1-1/4"	35	65	0,36
VCTW3A02411009	2"x1-1/2"	35	65	0,3
VCTW3A02410908	2"-1/2"x2"	46	80	0,55
VCTW3A02411109	3"x2-1/2"	48	93	0,84

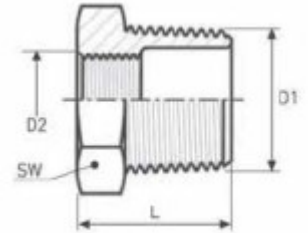

## Riduzione BSPP-F x BSPT-M

AISI 316 SS, BSP (ISO 7/1), PN 10

Codice	Taglia (D2 x D1)	L
VCTW3A02460201	1/4"x1/8"	27
VCTW3A02460302	3/8"x1/4"	30
VCTW3A02460303	3/8"x3/8"	31
VCTW3A02460403	1/2"x3/8"	35
VCTW3A02460404	1/2"x1/2"	38
VCTW3A02460504	3/4"x1/2"	39
VCTW3A02460505	3/4"x3/4"	41
VCTW3A02460604	1"x3/4"	44
VCTW3A02460606	1"x1"	46

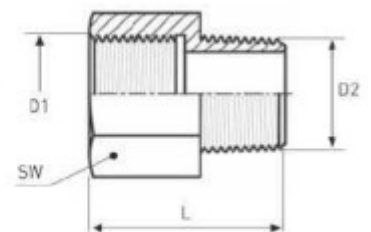

# Niplo di riduzione

AISI 316 SS, BSP (ISO 7/1), PN 10; disponibile anche in ottone

Codice	Taglia	L	SW
VCTW3A02450201	1/4"x1/8"	31	17
VCTW3A02450302	3/8"x1/4"	35	19
VCTW3A02450402	1/2"x1/4"	40	23
VCTW3A02450403	1/2"x3/8"	40	23
VCTW3A02450503	3/4"x3/8"	42	29
VCTW3A02450504	3/4"x1/2"	45	29
VCTW3A02450603	1"x3/8"	46	36
VCTW3A02450604	1"x1/2"	47	36
VCTW3A02450605	1"x3/4"	53	36
VCTW3A02450704	1-1/4"x1/2"	56	46
VCTW3A02450705	1-1/4"x3/4"	52	46
VCTW3A02450706	1-1/4"x1"	53	46
VCTW3A02450805	1-1/2"x3/4"	50	54
VCTW3A02450806	1-1/2"x1"	55	54
VCTW3A02450807	1-1/2"x1-1/4"	56	54
VCTW3A02450906	2"x1"	60	65
VCTW3A02450907	2"x1-1/4"	63	65
VCTW3A02451009	2"x1-1/2"	64	65
VCTW3A02450908	2"-1/2"x2"	74	80
VCTW3A024561109	3"x2-1/2"	81	93

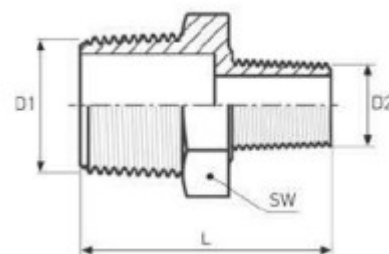

## Manicotto

AISI 316L SS, BSP (ISO 7/1), PN 10

Codice	Taglia	L	D
VCTW3A027001	1/8"	17	15
VCTW3A027002	1/4"	25	18,5
VCTW3A027003	3/8"	26	21,3
VCTW3A027004	1/2"	34	26,6
VCTW3A027005	3/4"	36	31,8
VCTW3A027006	1"	43	39,5
VCTW3A027007	1-1/4"	48	48,3
VCTW3A027008	1-1/2"	48	54,5
VCTW3A027009	2"	56	66,2
VCTW3A027010	2-1/2"	65	82
VCTW3A027011	3"	71	95
VCTW3A027012	4"	83	121,4

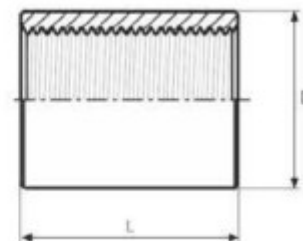

## Nipplo

AISI 316 SS, BSP (ISO 7/1), PN 10; disponibile anche in ottone

Codice	Taglia	L	SW
VCTW3A028001	1/8"	25	12
VCTW3A028002	1/4"	35	14
VCTW3A028003	3/8"	37	20
VCTW3A028004	1/2"	41	23
VCTW3A028005	3/4"	46	27
VCTW3A028006	1"	50	36
VCTW3A028007	1-1/4"	56	46
VCTW3A028008	1-1/2"	58	50
VCTW3A028009	2"	66	65
VCTW3A028010	2-1/2"	79	80
VCTW3A028011	3"	83	92
VCTW3A028012	4"	96	118

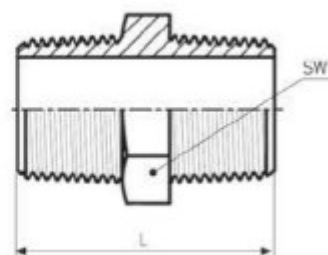



## Nipplo corto

AISI 316L SS, BSP (ISO 7/1), PN 10

Codice	Taglia	L
VCTW3A053102	1/4"	18
VCTW3A053103	3/8"	30
VCTW3A053104	1/2"	30
VCTW3A053105	3/4"	35
VCTW3A053106	1"	39
VCTW3A053107	1-1/4"	45
VCTW3A053108	1-1/2"	48
VCTW3A053109	2"	55

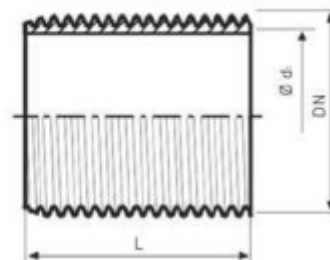

## Tappo maschio

AISI 316 SS, BSP (ISO 7/1), PN 10, disponibile anche in ottone

Codice	Taglia	L	SW
VCTW3A029001	1/8"	19	12
VCTW3A029002	1/4"	19	16
VCTW3A029003	3/8"	19	19
VCTW3A029004	1/2"	22	23
VCTW3A029005	3/4"	26	28
VCTW3A029006	1"	28	36
VCTW3A029007	1-1/4"	33	46
VCTW3A029008	1-1/2"	35	50
VCTW3A029009	2"	39	65
VCTW3A029010	2-1/2"	46	81
VCTW3A029011	3"	49	92
VCTW3A029012	4"	54	117

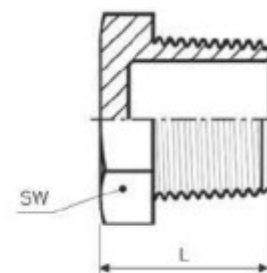

## Tappo femmina

AISI 316 SS, BSP (ISO 7/1), PN 10, disponibile anche in ottone

Codice	Taglia	L	SW
VCTW3A030001	1/8"	13	15
VCTW3A030002	1/4"	15	18
VCTW3A030003	3/8"	17	22
VCTW3A030004	1/2"	20	26
VCTW3A030005	3/4"	24	32
VCTW3A030006	1"	26	39
VCTW3A030007	1-1/4"	28	48
VCTW3A030008	1-1/2"	30	54
VCTW3A030009	2"	33	69
VCTW3A030010	2-1/2"	38	84
VCTW3A030011	3"	40	99
VCTW3A030012	4"	50	125

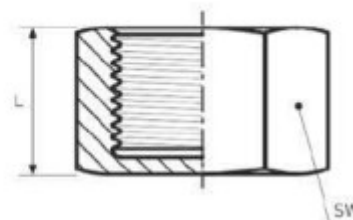

## Dado

AISI 316 SS, BSP (ISO 7/1), PN 10

Codice	Taglia	L	SW
VCTW3A031201	1/8"	6	19
VCTW3A031202	1/4"	6	22
VCTW3A031203	3/8"	7	27
VCTW3A031204	1/2"	8	32
VCTW3A031205	3/4"	9	37
VCTW3A031206	1"	10	46
VCTW3A031207	1-1/4"	11	55
VCTW3A031208	1-1/2"	12	62
VCTW3A031209	2"	13	76
VCTW3A031210	2-1/2"	15	95
VCTW3A031211	3"	19,5	106

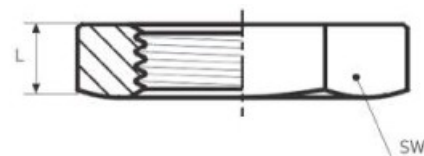

## Giunto a 3 pezzi femmina

AISI 316 SS, BSP (ISO 7/1), PN 10

Codice	Taglia	L	SW
VCTW3A034002	1/4"	42	29
VCTW3A034003	3/8"	45	34
VCTW3A034004	1/2"	48	39
VCTW3A034005	3/4"	52	47
VCTW3A034006	1"	58	58
VCTW3A034007	1-1/4"	65	67
VCTW3A034008	1-1/2"	70	77
VCTW3A034009	2"	78	90
VCTW3A034010	2-1/2"	85	110
VCTW3A034011	3"	95	130
VCTW3A034012	4"	110	157

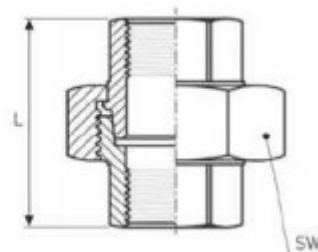

## Giunto a 3 pezzi maschio - femmina

AISI 316 SS, BSP (ISO 7/1), PN 10

Codice	Taglia	L
VCTW3A034102	1/4"	54
VCTW3A034103	3/8"	58
VCTW3A034104	1/2"	65
VCTW3A034105	3/4"	70
VCTW3A034106	1"	79
VCTW3A034107	1-1/4"	89
VCTW3A034108	1-1/2"	94
VCTW3A034109	2"	104
VCTW3A034110	2-1/2"	117
VCTW3A034111	3"	130
VCTW3A034112	4"	156

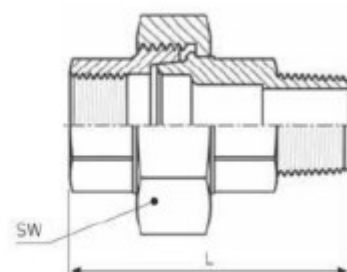

# Portagomma

AISI 316 SS, BSP (ISO 7/1), PN 10, disponibile anche in ottone

Codice	Taglia	L	S	D1
VCTW3A039902	1/4"	47	15	9
VCTW3A039903	3/8"	50	19	13
VCTW3A039904	1/2"	65	23	15
VCTW3A039905	3/4"	70	29	20
VCTW3A039906	1"	75	38	25
VCTW3A039907	1-1/4"	82	46	33
VCTW3A039908	1-1/2"	95	52	39
VCTW3A039909	2"	105	63	51

